

IMPORTANT SAFETY INSTRUCTIONS

Before you install or use the apparatus, you must read and understand these Important Safety Instructions. At all times when using the apparatus you must follow these Important Safety Instructions to reduce the risk of fire, electrical shock and injury to persons.

1. **Read these instructions.**
2. **Keep these instructions.**
3. **Heed all warnings.**
4. **Follow all instructions.**
5. **Do not use this apparatus near water.**
6. **Clean only with dry cloth.**
7. **Do not block any ventilation openings. Install in accordance with the manufacturer's instructions.**
8. **Do not install near any heat sources such as radiators, heat registers, stoves, or other apparatus (including amplifiers) that produce heat.**
9. **Do not defeat the safety purpose of the polarized or grounding-type plug. A polarized plug has two blades with one wider than the other. A grounding type plug has two blades and a third grounding prong. The wide blade or the third prong are provided for your safety. If the provided plug does not fit into your outlet, consult an electrician for replacement of the obsolete outlet.**
10. **Protect the power cord from being walked on or pinched particularly at plugs, convenience receptacles, and the point where they exit from the apparatus.**
11. **Only use attachments/accessories specified by the manufacturer.**
12. **Use only with the cart, stand, tripod, bracket, or table specified by the manufacturer, or sold with the apparatus. When a cart is used, use caution when moving the cart/apparatus combination to avoid injury from tip-over.**
13. **Unplug this apparatus during lightning storms or when unused for long periods of time.**
14. **Refer all servicing to qualified service personnel. Servicing is required when the apparatus has been damaged in any way, such as power-supply cord or plug is damaged, liquid has been spilled or objects have fallen into the apparatus, the apparatus has been exposed to rain or moisture, does not operate normally, or has been dropped.**



SAFETY INFORMATION

This digital set-top has been manufactured and tested with your safety in mind. However, improper use can result in potential electric shock or fire hazards. To avoid defeating the safeguards that have been built into your set-top, please observe the precautions discussed in this document.

Warnings on your set-top



The lightning flash with arrowhead symbol, within a triangle, is intended to alert you to the presence of uninsulated “dangerous” voltages within your set-top’s enclosure that may be of sufficient magnitude to constitute a risk of electric shock to persons.

The exclamation point within a triangle is intended to alert you to the presence of important instructions in the literature accompanying your set-top.

Other warnings

TO REDUCE THE RISK OF ELECTRIC SHOCK, DO NOT REMOVE THE COVER OF YOUR SET-TOP. THERE ARE NO USER-SERVICEABLE PARTS INSIDE IT.

TO REDUCE THE RISK OF FIRE OR ELECTRIC SHOCK, DO NOT EXPOSE THIS SET-TOP TO RAIN OR MOISTURE.

DO NOT PERFORM ANY SERVICING UNLESS YOU ARE QUALIFIED TO DO SO BY PACE. REFER ALL SERVICING TO QUALIFIED SERVICE PERSONNEL.

SERVICING THE SET-TOP YOURSELF WILL INVALIDATE THE WARRANTY.

In addition to the Important Safety Instructions, please read the Safety Information below.

Power sources

You must operate your set-top only from the type of power source indicated on the marking label. If you are not sure of the type of power supply to your home, consult your dealer or local power company.

Overloading

Do not overload wall outlets, extension cords or other power outlets as this can result in a risk of fire or electric shock.

Risk of fire or scorching

Never place naked flame sources, such as lighted candles, on your set-top.

INSTALLATION

The installation of your set-top should be carried out by a qualified installer and should conform to local codes.

Note to the installer

This reminder is provided to call the attention of the cable-TV-system installer to Section 820-40 of the National Electrical Code (USA), which provides guidelines for proper grounding and, in particular, specifies that the cable ground shall be connected to the grounding system of the building, as close to the point of cable entry as is practical.

Service address:

Pace Micro Technology (Support Services) Ltd.
3701 FAU Boulevard, Suite 200
Boca Raton
Florida, 33431, U.S.A.



Manufactured under license from Dolby Laboratories. “Dolby” and the double-D symbol are trademarks of Dolby Laboratories. Confidential Unpublished Works. ©1992-1997 Dolby Laboratories, Inc. All rights reserved.

This product incorporates copyright protection technology that is protected by U.S. patents and other intellectual property rights. Use of this copyright protection technology must be authorized by Macrovision, and is intended for home and other limited pay-per-view— uses only unless otherwise authorized by Macrovision. Reverse engineering or disassembly is prohibited.

Pace and  are trademarks and/or registered trademarks of Pace Micro Technology plc.

PowerKEY and the PowerKEY design are registered trademarks of Scientific-Atlanta, Inc.

Other trade marks listed herein are the property of their respective owners.

The model and serial number of your Pace DC501P set-top are on a label on its base.

Copyright © 2005 Pace Micro Technology plc All rights reserved

Placement and mounting

Do not place your set-top on an unstable or uneven surface. Your set-top may fall, causing serious injury to a child or adult and serious damage to your set-top. If you mount your set-top, for example to a wall or ceiling, follow the manufacturer’s instructions and use a mounting accessory recommended by the manufacturer. See also item 12 in the Important Safety Instructions.

Ventilation

Slots and openings in the casing of your set-top are provided for ventilation, to ensure reliable operation of your set-top and to protect it from overheating.

- never block the ventilation openings by placing your set-top on a bed, sofa, rug or other similar surface;
- never cover the ventilation openings with items such as newspapers, tablecloths or curtains;
- do not place your set-top in a built-in installation such as a bookcase or rack unless proper ventilation is provided or you have adhered to the manufacturer’s instructions;
- maintain a minimum distance of 3 inches around your set-top for sufficient ventilation.

See also item 7 in the Important Safety Instructions.

Ambient temperature

The operating temperature range of your set-top is 32-104°F. If the ambient temperature around your set-top falls outside this range, you must correct this in order for your set-top to work correctly and safely. For example, if the temperature is too high, switch on the air conditioning.

Water and moisture

Do not expose this set-top to dripping or splashing and ensure that no objects filled with liquids, such as vases, are placed on your set-top. See also item 5 in the Important Safety Instructions.

Entry of objects and liquids

Never push objects of any kind into your set-top through openings as they may touch dangerous voltage points or short-out parts that could result in fire or electric shock. Never spill liquid of any kind on your set-top.

Power lines

You must not locate an outside antenna system in the vicinity of overhead power lines or other electric light or power circuits, or where it can fall into such power lines or circuits. When installing an outside antenna system, you must take extreme care to avoid touching such power lines or circuits, as contact with them might be fatal.

TERMS AND CONDITIONS FOR USE OF SOFTWARE (“TERMS”)

THE PRODUCT TO WHICH THESE TERMS RELATE (THE “PRODUCT”) INCORPORATES SOFTWARE WHICH IS OWNED BY PACE MICRO TECHNOLOGY PLC (“PACE”) OR ITS THIRD PARTY LICENSORS (THE “SOFTWARE”). BEFORE USING THE PRODUCT PLEASE READ THESE TERMS. IF YOU DO NOT AGREE TO THESE TERMS YOU MAY NOT USE THE PRODUCT AND SHOULD IMMEDIATELY RETURN THE PRODUCT TO YOUR SUPPLIER. THESE TERMS ALSO APPLY TO ANY MODIFICATIONS, UPDATES OR SUPPLEMENTS TO THE SOFTWARE PROVIDED TO YOU. FOR PURPOSES OF THESE TERMS, “YOU” MEANS YOU, THE END USER, AND YOUR PRODUCT SUPPLIER, UNLESS THE CONTEXT REQUIRES OTHERWISE.

A. License Grant and Conditions

1. Pace, or your supplier, if applicable, grants you a non-exclusive, non-transferable, limited license to use the Software solely as integrated with, incorporated into, or provided for use in connection with the Product.
2. Pace reserves all rights not expressly granted to you under these Terms.
3. You may not transfer any of your limited rights in the Software without the prior written consent of Pace, and if consent is provided then the Software shall only be transferred in conjunction with the transfer of the Product AND ONLY IF the transferee has read and agreed to accept these Terms.
4. You must ensure that the copyright, trademark and other protective notices contained in the Software are maintained and not altered or removed.
5. The Software is protected by copyright and other laws and international copyright and other treaties.
6. The Software provided hereunder is licensed (not sold). Pace is NOT transferring title or any ownership rights in the Software to you.
7. All title and intellectual property rights in and to the Software and all modifications, updates, enhancements and derivative works of the Software are owned exclusively by Pace or its licensors and you agree to execute any document reasonably requested by Pace to evidence such ownership rights.
8. Certain third party software used in connection with the Product may be made directly available to you by operating system or other third party providers. Use of such Software is also subject to the terms of any applicable agreement between you and such third party.

B. License Restrictions

Except as expressly permitted by statute **you may not:**

1. use the Software in conjunction with any other hardware or equipment other than the Product;

Outdoor antenna grounding

Be sure that any outside antenna or cable system connected to your set-top is grounded so as to provide some protection against voltage surges and static charges that have built up. Article 810 of the National Electrical Code (USA), ANSI/NFPA 70 provides information with regard to proper grounding of the mast and supporting structure, grounding of the lead-in wire to an antenna-discharge unit, size of grounding conductors, location of antenna-discharge unit, connection to grounding electrodes and requirements for the grounding electrode. See the diagram below.

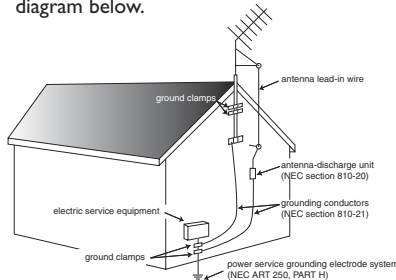

(Example antenna grounding as per National Electrical Code, ANSI/NFPA 70)

Transporting

Move the combination of set-top and cart with care. Quick stops, excessive force and uneven surfaces may cause the combination of set-top and cart to overturn. See also item 12 in the Important Safety Instructions.

2. copy or modify all or any portion of the Software;
3. incorporate all (or any portion of) the Software into other programs developed or used by (or on behalf of) you;
4. reverse engineer, decompile, decrypt or disassemble the Software (or any portion of the Software); or
5. export, transfer or re-export the Software in violation of any applicable law.

C. Termination

These Terms are effective until terminated. You may terminate these Terms by returning the Product to your supplier. These Terms will terminate automatically without notice if you fail to comply with these Terms or any other written agreement between you and Pace. Upon termination you must return the Product to your supplier.

D. Disclaimer

1. EXCEPT AS SET FORTH IN ANY WRITTEN AGREEMENT BETWEEN YOU AND PACE (OR YOUR SUPPLIER), THE SOFTWARE IS (TO THE EXTENT PERMITTED BY LAW) SUPPLIED “AS IS” AND PACE AND ITS LICENSORS EXPRESSLY EXCLUDE ALL WARRANTIES, EXPRESS OR IMPLIED, INCLUDING (BUT NOT LIMITED TO) WARRANTIES OF MERCHANTABILITY, SATISFACTORY QUALITY, FITNESS FOR PURPOSE AND NON-INFRINGEMENT.
2. EXCEPT AS SET FORTH IN ANY WRITTEN AGREEMENT BETWEEN YOU AND PACE, IN NO CIRCUMSTANCE WILL PACE BE LIABLE FOR ANY DIRECT, INDIRECT, CONSEQUENTIAL, SPECIAL, PUNITIVE OR INCIDENTAL DAMAGE (INCLUDING LOSS OF PROFITS, BUSINESS INTERRUPTION, LOSS OF DATA OR THE COST OF PROCUREMENT OF SUBSTITUTE GOODS, TECHNOLOGY OR SERVICES) ARISING OUT OF THE USE OR THE INABILITY TO USE THE SOFTWARE.

E. General

These Terms are governed by the laws of the State of New York and you may only bring claims exclusively in New York courts and Pace shall be entitled to bring a claim in the courts of any jurisdiction. Any failure by Pace to enforce any of its rights hereunder or applicable law shall not constitute a waiver of such rights. Pace’s licensors and suppliers shall be third party beneficiaries of this License Agreement, as applicable.

YOUR USE OF THE PRODUCT CONSTITUTES YOUR ACKNOWLEDGEMENT THAT YOU HAVE READ THESE TERMS AND AGREE TO BE BOUND HEREBY.

NOTE

Your set-top has been tested and found to comply with the limits for a Class B digital device, pursuant to Part 15 of the FCC Rules. These limits are designed to provide reasonable protection against harmful interference in a residential installation. Your set-top generates, uses and can radiate radio-frequency energy and, if not installed and used in accordance with the instructions, may cause harmful interference to radio communications.

However, there is no guarantee that interference will not occur in a particular installation. If your set-top does cause harmful interference to radio or television reception, which can be determined by turning your set-top off and on, you are encouraged to try to correct the interference by one or more of the following measures:

- Reorient or relocate the receiving antenna.
- Increase the separation between your set-top and the receiver.
- Connect your set-top to an outlet on a circuit different from that to which the receiver is connected.
- Consult your dealer or an experienced radio/TV technician for help.



Thank you for choosing the Pace DC501P Set-Top.
Follow the set-up instructions in this Quick Start Guide to ensure you get the best from your set-top.
To ensure you use this product safely, please read all the safety information included in this document.

1. YOUR SET-TOP'S FRONT PANEL

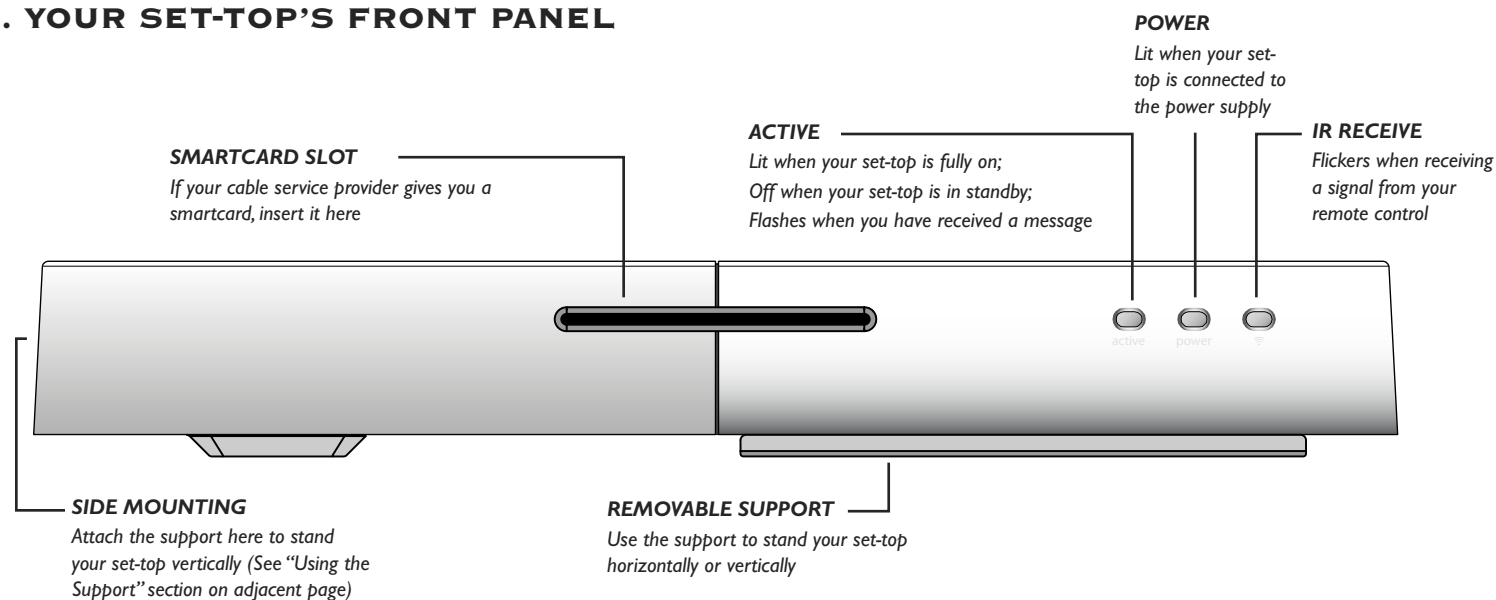

2. CONNECTING UP YOUR SET-TOP

WARNINGS

Do not connect your set-top (or any other equipment such as a TV or VCR) to the AC power supply until you have properly connected all the other cables.
Disconnect you set-top from the AC power supply before you disconnect any other equipment from its rear panel.
The cable input is designed for connection to a cable network only. You must not connect any other equipment, such as a VCR, to this input.

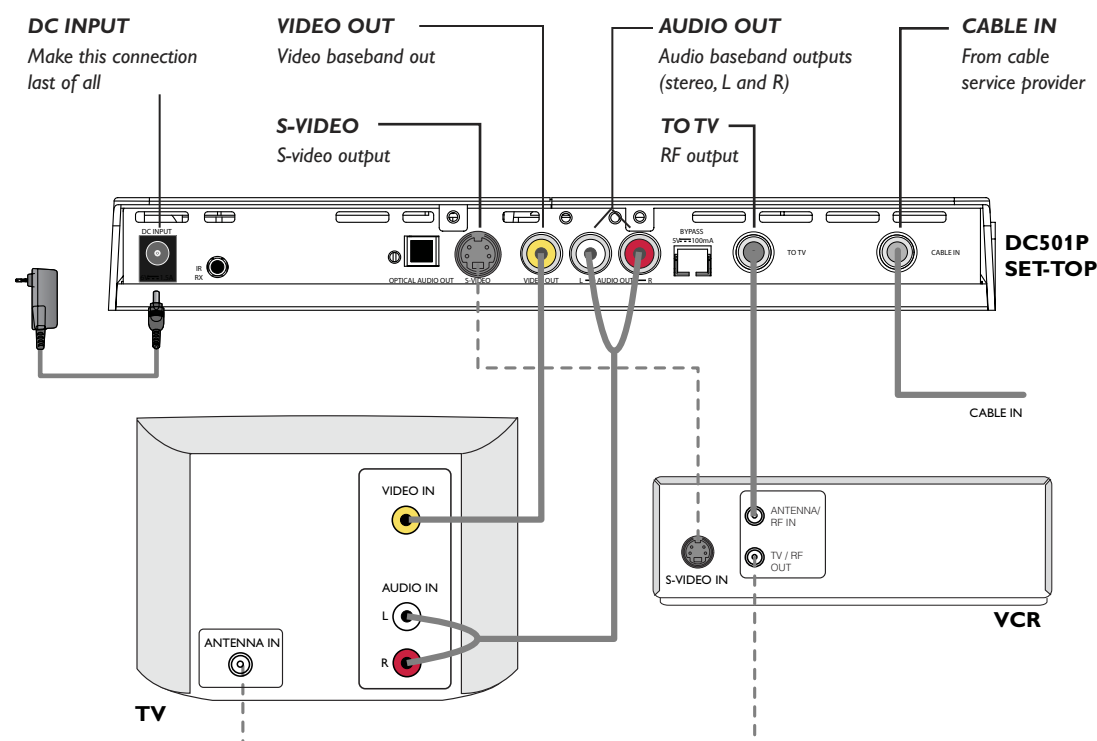

Connecting to a TV and VCR

Before starting, choose a suitable position for your set-top, observing the ventilation requirements set out on the other side of this sheet.

1. Connect the cable service to the connector marked CABLE IN on your set-top.
2. Connect your set-top to your TV via the video baseband connectors, as shown.
3. Connect audio baseband cables to your TV, as shown. The VCR and RF connection are optional.
4. Connect the cord from the plug-mounted power supply into the socket marked DC Input on your set-top.
5. When all the connections are properly made, connect all equipment to the AC power supply.

3. CONNECTING TO THE AC POWER SUPPLY

Your set-top itself is designed for use only with the supplied plug-mounted power supply.

On the plug-mounted power supply there is a label which specifies the correct AC power supply input for it. Do not connect the plug-mounted power supply to any supply other than this.

Always connect the 6 Volt cord to your set-top before you insert the plug-mounted power supply into the AC power supply.

To disconnect power from your set-top, always remove the plug-mounted power supply from the wall socket-outlet (i.e. not by removing the 6 Volt cord from your set-top). Therefore you must install your set-top near to the wall socket-outlet, which should be easily accessible.

If you are in any doubt about the plug-mounted power supply, its cord or its connection, consult a competent electrician.

4. USING YOUR DC501P SET-TOP

Switching your set-top on and off

To switch on the set-top, first insert the plug-mounted power supply into the AC power supply, then connect the 6 Volt cord to your set-top.

To switch off the set-top, remove the plug-mounted power supply from the wall socket-outlet (i.e. not by removing the 6 Volt cord from your set-top).

Using your set-top

Refer to the instructions supplied by your cable service provider for information on changing channels and using the remote control and on-screen TV guide.

USING THE SUPPORT

You can use the removable support on the base of your set-top to lie the set-top flat or stand it on its end.

Your set-top is supplied with the support attached to the base, to lie in a horizontal position.

To stand your set-top on its end:

1. Remove the support by turning it counter-clockwise until it comes free of your set-top.
2. Attach the support to the side mounting (the raised area on the left-hand end of your set-top), and turn it clockwise as far as it will turn without forcing it.

Your set-top will now stand securely on its end, as pictured right.

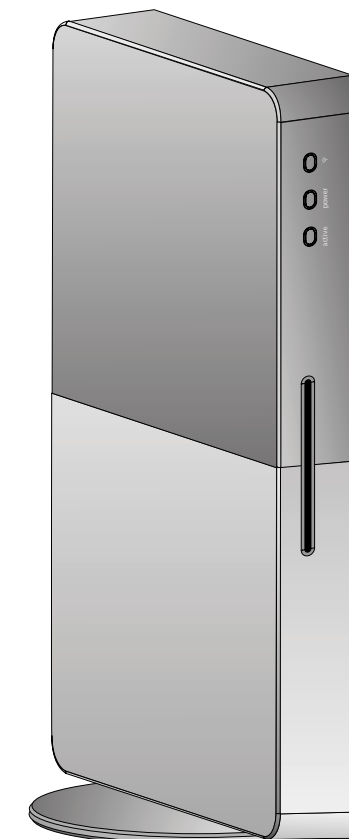

SOLVING PROBLEMS

If the installed system does not seem to be working properly, first make sure that all the cables are securely connected, then carry out the following checks, in the order shown.

Check	Suggested solution	Further checks, if there is still a problem
Is anything lighted on your set-top's front panel? YES ▼	NO ▶ Power may not be reaching your set-top. Make sure that the plug-mounted power supply is properly plugged in. If there is a switch by the wall AC power outlet, switch it to ON.	Check that the wall AC power outlet is working (for example by plugging in a lamp).
Does the remote control operate your set-top? YES ▼	NO ▶ Check that nothing is blocking the path from your remote control to the front panel.	Check that your remote control is currently set to operate your set-top (consult the instructions supplied with your remote control). If your remote control will still not operate your set-top, replace the batteries in your remote control.
Can you see a picture on your TV screen? YES ▼	NO ▶ Your TV and other equipment may not be turned on. Check that they are plugged into AC power outlets and turned on.	If your stereo TV is connected by baseband AV cables, check that you have selected the appropriate baseband input on your TV. If your TV and VCR are connected by RF coaxial cables, they must be tuned to your set-top's output channel. This is channel 3 or channel 4 (contact your cable operator to find out which it is). Tune your TV and VCR to this channel. If the video path between your set-top and your TV loops through other equipment (such as a VCR) you may need to turn off this equipment for the loopthrough to work.
Is the picture distorted or too small? NO ▼	YES ▶ Your TV and/or VCR may not be tuned to your set-top's output channel.	Make sure that the TV/VCR switch on your VCR is switched to "TV".
Is there any sound?	NO ▶ Make sure that the TV/VCR switch on your VCR is switched to "TV".	Check that you have not muted the sound on your set-top, TV and/or any attached audio equipment. Adjust the volume control on your set-top and/or TV. If you can hear only mono sound, first check that the program is likely to have stereo sound (an old movie, for example, may not be in stereo).