



# Pace 510 Home Terminal

operator's manual



When you switch off your home terminal, it still uses some power (unless you unplug it at the wall socket-outlet). However, the Pace 510 home terminal complies with ENERGY STAR guidelines for energy efficiency and therefore displays the ENERGY STAR label shown above. This means that, when this home terminal is off, it consumes much less power than similar, non-labeled products. ENERGY STAR is a dynamic industry/government partnership that makes it easy for businesses and consumers to save money and protect the environment.

This product incorporates copyright protection technology that is protected by U.S. patents and other intellectual property rights. Use of this copyright protection technology must be authorized by Macrovision, and is intended for home and other limited pay-per-view uses only unless otherwise authorized by Macrovision. Reverse engineering or disassembly is prohibited.



Manufactured under license from Dolby Laboratories.  
 "Dolby" and the double-D symbol are trademarks of  
 Dolby Laboratories. Confidential Unpublished Works.  
 ©1992-1997 Dolby Laboratories, Inc. All rights reserved.

Pace<sup>®</sup> and  are the trade marks and/or registered trade marks of Pace Micro Technology plc.

PowerKEY and the PowerKEY design are registered trademarks of Scientific-Atlanta, Inc.

Other trademarks listed herein are the property of their respective owners.

**IMPORTANT SAFETY INSTRUCTIONS ..... 2**  
**REAR PANEL ..... 8**  
**CONNECTING TO THE AC POWER SUPPLY ..... 10**  
**TURNING ON AND TUNING IN ..... 12**  
**OPERATING YOUR HOME TERMINAL ..... 14**  
**FRONT PANEL ..... 16**  
**SOLVING PROBLEMS ..... 17**

**The model and serial number of the Pace 510 home terminal are on a label on its base.**

**This manual, with related information, is available on the Pace website at:**

**[www.pacemicro.com/products/products.asp?id=510](http://www.pacemicro.com/products/products.asp?id=510)**

**Copyright © 2002  
 Pace Micro Technology plc  
 All rights reserved**

## IMPORTANT SAFETY INSTRUCTIONS

This digital home terminal has been manufactured and tested with your safety in mind. However, improper use can result in potential electric shock or fire hazards. To avoid defeating the safeguards that have been built into your home terminal, please observe the precautions discussed in this manual.

### WARNINGS ON YOUR HOME TERMINAL



The lightning flash with arrowhead symbol, within a triangle, is intended to alert you to the presence of uninsulated “dangerous” voltages within your home terminal’s enclosure that may be of sufficient magnitude to constitute a risk of electric shock to persons.



The exclamation point within a triangle is intended to alert you to the presence of important instructions in the literature accompanying your home terminal.

### OTHER WARNINGS

**TO REDUCE THE RISK OF ELECTRIC SHOCK, DO NOT REMOVE THE COVER OF YOUR HOME TERMINAL. THERE ARE NO USER-SERVICEABLE PARTS INSIDE IT.**

**TO PREVENT FIRE OR SHOCK HAZARDS, DO NOT EXPOSE YOUR HOME TERMINAL TO RAIN OR MOISTURE.**

**DO NOT PERFORM ANY SERVICING UNLESS YOU ARE QUALIFIED TO DO SO. REFER ALL SERVICING TO QUALIFIED SERVICE PERSONNEL.**

### INSTALLATION

The installation of your home terminal should be carried out by a qualified installer and should conform to local codes.

#### Note to the installer

This reminder is provided to call the attention of the cable-TV-system installer to Section 820-40 of the National Electrical Code (USA), which provides guidelines for proper grounding and, in particular, specifies that the cable ground shall be connected to the grounding system of the building, as close to the point of cable entry as is practical.

When using your home terminal, you must follow these basic safety precautions to reduce the risk of fire, electrical shock and injury to persons.

### **Read, understand and follow instructions**

Read and understand all the safety instructions before you operate your home terminal.

### **Heed warnings**

Adhere to all warnings and instructions marked on your home terminal and in these safety and operating instructions.

### **Power sources**

You must operate your home terminal only from the type of power source indicated on the rear panel of your home terminal. If you are not sure of the type of power supply to your home, consult your dealer or local power company.

Do not defeat the safety purpose of the polarized or grounding-type plug. A polarized plug has two blades with one wider than the other. This plug fits into the socket in only one way; match the wide blade of the plug to the wide slot.

A grounding-type plug has two blades and a third grounding prong. The wide blade or the third prong are provided for your safety.

If the provided plug does not fit into your outlet, consult an electrician for replacement of the obsolete outlet.

### **Protection of the power cord**

Route power-supply cords so that they are unlikely to be walked on or pinched by items placed upon them or against them. Pay particular attention to cords at plugs, convenience receptacles and the point where they leave your home terminal.

### **Overloading**

Do not overload wall outlets, extension cords or integral convenience receptacles as this can result in a risk of fire or electric shock.

### **Lightning**

For added protection for your home terminal during a lightning storm, or when it is left unattended and unused for long periods of time, unplug it from the wall outlet and disconnect the antenna and cable system. This prevents your home terminal from being damaged by lightning and power-line surges.

### **Placement and mounting**

Do not place your home terminal on an unstable cart, stand, tripod, bracket or table. Your home terminal may fall, causing serious injury to a child or adult and serious damage to your home terminal. Use only with a cart, stand, tripod, bracket or table recommended by the manufacturer; or sold with your home terminal. If you do mount your home terminal, follow the manufacturer's instructions and use a mounting accessory recommended by the manufacturer. If you mount your home terminal to a wall or ceiling, do so only as recommended by the manufacturer:

## IMPORTANT SAFETY INSTRUCTIONS (CONT.)

### Outdoor antenna grounding

Be sure that any outside antenna or cable system connected to your home terminal is grounded so as to provide some protection against voltage surges and static charges that have built up. Article 810 of the National Electrical Code (USA), ANSI/NFPA 70 provides information with regard to proper grounding of the mast and supporting structure, grounding of the lead-in wire to an antenna-discharge unit, size of grounding conductors, location of antenna-discharge unit, connection to grounding electrodes and requirements for the grounding electrode. See the diagram below.

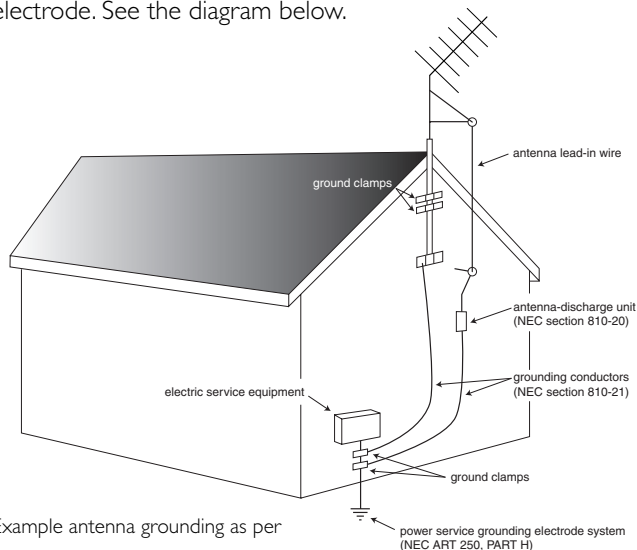

Example antenna grounding as per National Electrical Code ANSI/NFPA 70

### Power lines

You must not locate an outside antenna system in the vicinity of overhead power lines or other electric light or power circuits, or where it can fall into such power lines or circuits. When installing an outside antenna system, you must take extreme care to avoid touching such power lines or circuits, as contact with them might be fatal.

### Transporting

Move your combination of home terminal and cart with care. Quick stops, excessive force and uneven surfaces may cause the combination of home terminal and cart to overturn.



### Attachments

Do not use attachments which are not recommended by the manufacturer of your home terminal, as they may cause hazards.

### Heat

Situate your home terminal away from heat sources such as radiators, heat registers, stoves or other products (including amplifiers) that produce heat.

### **Ventilation**

Slots and openings in the casing of your home terminal are provided for ventilation, to ensure reliable operation of your home terminal and to protect it from overheating. These openings must not be blocked or covered. Never block the openings by placing your home terminal on a bed, sofa, rug or other similar surface. Do not place your home terminal in a built-in installation such as a bookcase or rack unless proper ventilation is provided or you have adhered to the manufacturer's instructions.

### **Water and moisture**

Do not use your home terminal near water; for example, near a bath tub, wash bowl, kitchen sink or laundry tub; in a wet basement; or near a swimming pool. Do not expose your home terminal to dripping or splashing, and ensure that no objects filled with liquids, such as vases, are placed on your home terminal.

### **Entry of objects and liquids**

Never push objects of any kind into your home terminal through openings, as they may touch dangerous voltage points or short-out parts that could result in fire or electric shock. Never spill liquid of any kind on your home terminal.

### **Cleaning**

Unplug your home terminal from the wall outlet before cleaning. Do not use liquid cleaners or aerosol cleaners. Use a dry cloth for cleaning.

### **Servicing**

Do not attempt to service your home terminal yourself, as opening or removing its covers may expose you to dangerous voltage or other hazards. Incorrect reassembly may cause electric shock when your home terminal is subsequently used. Refer all servicing or repair work to qualified service personnel.

### **Damage requiring service**

Unplug your home terminal from the wall outlet and refer servicing to qualified service personnel under the following conditions:

- when the power-supply cord or plug is damaged;
- if liquid has been spilled, or objects have fallen, into your home terminal;
- if your home terminal has been exposed to rain or water;
- if your home terminal has been dropped or damaged in any way;
- if your home terminal exhibits a distinct change in performance; this indicates that it needs to be serviced.

### **Replacement parts**

When replacement parts are required, be sure that the service technician has used replacement parts specified by the manufacturer or that have the same characteristics as the original part. Unauthorized substitutions may result in fire, electric shock or other hazards.

## IMPORTANT SAFETY INSTRUCTIONS (CONT.)

### Safety check

Upon completion of any servicing or repairs to your home terminal, ask the service technician to perform safety checks to determine that your home terminal is in its proper operating condition.

### Retain instructions

SAVE THESE SAFETY INSTRUCTIONS FOR FUTURE REFERENCE

### Important safety information about connections

Do not connect your home terminal (or any other equipment such as a TV or VCR) to the AC power supply until you have properly connected all the other cables.

Your home terminal operates with a 120V AC, 60 Hz power supply. Do not connect it to a DC power supply.

Insert the power cord into your home terminal's POWER INPUT socket before you insert it into the AC power outlet on the wall. If the wall socket-outlet has a switch, switch this to its ON position to supply power to your home terminal.

Disconnect your home terminal from the AC power supply before you disconnect any other equipment from its rear panel.

The only way to disconnect your home terminal from the AC power supply is to remove the AC power cord (or switch the wall socket-outlet switch, if present, to its OFF position). Your home terminal must therefore be installed near to the AC power socket-outlet, which should be easily accessible.

This outlet is designed only for connection to the AC power cord for a **TV**. The maximum power it can supply is 500 watts. Do not connect any equipment that uses more than 500 watts, or any non-TV equipment such as a toaster or hair drier.

This input is designed for connection to a cable network only. You must not connect any other equipment, such as a VCR, to this input.

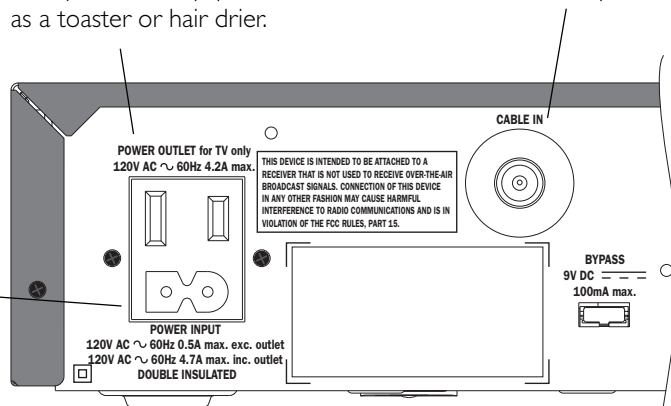

### Service address:

Pace Micro Technology (Support Services) Ltd.  
3701 FAU Boulevard, Suite 200  
Boca Raton  
Florida, 33431  
U.S.A.

### EPILEPSY AND ON-SCREEN IMAGES

Certain people are susceptible to epileptic fits or losing consciousness when faced with certain types of flashing lights in our daily environment.

These people are exposed to the risk of fits if they watch certain television images or if they view certain images while they are browsing the Web. These phenomena may appear even when the subject has no previous history of this problem or has never suffered an epileptic fit.

If you, or a member of your family, has already suffered symptoms linked to epilepsy (fit or loss of consciousness) in the presence of stimulation by light, please consult your doctor before using this product.

If you or any person using the equipment experiences dizziness, involuntary movements or convulsion, please immediately stop viewing and consult a doctor.

When you are browsing the Web or playing a Web-based game, take the following precautions:

- Use the equipment in a well-lit room, and turn down the brightness of your television screen.
- Sit at a reasonable distance from the television screen.
- Take a break for ten minutes every hour.

You should avoid using the Web if you are tired or have lost some sleep.

### REGULATORY INFORMATION

**CAUTION:** Do not attempt to modify your home terminal without written authorization from the manufacturer. Unauthorized modification could void your authority to operate your home terminal.

#### NOTE

Your home terminal has been tested and found to comply with the limits for a Class B digital device, pursuant to Part 15 of the FCC Rules. These limits are designed to provide reasonable protection against harmful interference in a residential installation. Your home terminal generates, uses and can radiate radio-frequency energy and, if not installed and used in accordance with the instructions, may cause harmful interference to radio communications.

However, there is no guarantee that interference will not occur in a particular installation. If your home terminal does cause harmful interference to radio or television reception, which can be determined by turning your home terminal off and on, you are encouraged to try to correct the interference by one or more of the following measures:

- Reorient or relocate the receiving antenna.
- Increase the separation between your home terminal and receiver.
- Connect your home terminal to an outlet on a circuit different from that to which the receiver is connected.
- Consult the dealer or an experienced radio/TV technician for help.

# REAR PANEL

**POWER OUTLET**  
(500 W max.)

**CABLE IN**  
From cable  
service-provider

**TO TV**  
RF output

**VIDEO OUT**  
Video baseband output

**VIDEO IN**  
Video baseband input

**DIGITAL AUDIO OUT**  
S/PDIF audio output

**SMART CARD slot**

**IR TRANSMIT**  
Infra-red output to control  
a VCR or other device

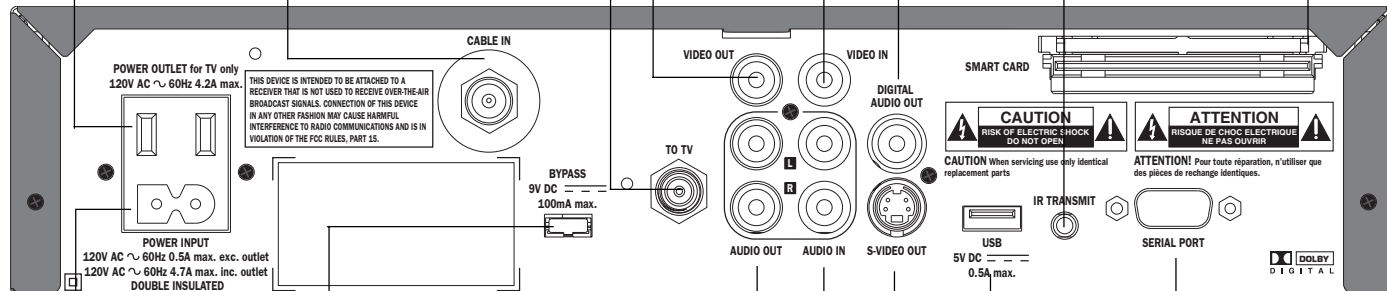

**BYPASS**  
For optional  
bypass module.

**AUDIO OUT**  
Audio baseband output  
(stereo, L and R)

**USB**  
Universal serial bus  
connector

**SERIAL PORT**  
RS232 connector

**POWER INPUT**  
(Make this connection last of all)

**AUDIO IN**  
Audio baseband input  
(stereo, L and R)

**S-VIDEO OUT**  
S-video baseband output

<b>POWER OUTLET</b>	Connect the TV's power cord here to provide AC power to your TV.
<b>POWER INPUT</b>	Connect your home terminal's power cord here.
<b>CABLE IN</b>	Connect the incoming cable service here. The optional bypass module also connects here.
<b>BYPASS</b>	Connect the optional bypass module here, so that it can receive its power from your home terminal.
<b>TO TV</b>	Connect to the antenna/cable input on your TV or VCR.
<b>VIDEO OUT</b>	Connect to the video baseband input on your TV or VCR.
<b>AUDIO OUT</b>	Connect to the stereo audio inputs on your stereo TV, stereo VCR or optional stereo amplifier.
<b>VIDEO IN</b>	Connect to the video baseband output on your DVD (or similar equipment).
<b>AUDIO IN</b>	Connect to the stereo audio outputs on your DVD (or similar).
<b>DIGITAL AUDIO OUT</b>	Connect to the digital audio input on optional digital audio equipment, such as an audio decoder or home theater receiver.
<b>S-VIDEO OUT</b>	Connect to the S-video baseband input (if present) on your TV or VCR.
<b>USB</b>	Connect to any optional equipment that supports a USB interface, for example: a digital camera, keyboard or mouse.
<b>IR TRANSMIT</b>	Connect to an optional IR transmitter to control other equipment.
<b>SERIAL PORT</b>	Not used at the present time.
<b>SMART CARD</b>	Do not use this smart card slot unless your cable operator asks you to.

### WARNINGS

Do not connect your home terminal (or any other equipment such as a TV or VCR) to the AC power supply until you have properly connected all the other cables.

Disconnect your home terminal from the AC power supply before you disconnect any other equipment from its rear panel.

The power outlet is designed only for connection to the AC power cord for a TV. The maximum power it can supply is 500 watts. Do not connect any equipment that uses more than 500 watts, or any non-TV equipment such as a toaster or hair drier.

The cable input is designed for connection to a cable network only. You must not connect any other equipment, such as a VCR, to this input.

Any cable connected to DIGITAL AUDIO OUT must be 75 ohm coaxial, not regular audio cable.

## CONNECTING TO THE AC POWER SUPPLY

### WARNINGS

Do not connect your home terminal (or any other equipment such as a TV or VCR) to the AC power supply until you have properly connected all the other cables.

Do not defeat the safety purpose of the polarized plugs on power cords. A polarized plug has two blades with one wider than the other. This plug fits into the outlet in only one way; match the wide blade of the plug to the wide slot of the outlet.

Disconnect your home terminal from the AC power supply before you disconnect any other equipment from its rear panel.

The only way to disconnect your home terminal from the AC power supply is to remove the AC power cord (or switch the wall socket-outlet switch, if present, to its OFF position). Your home terminal must therefore be installed near to the AC power socket-outlet, which should be easily accessible.

### Connecting your TV to the AC power supply

If your TV has a rating of less than 500 W, connect the power cord from your TV into the connector labeled "POWER OUTLET" on the rear panel of your home terminal. This saves a wall outlet (although, if your TV is rated 500 W or more, you must connect it to a wall outlet).

### Connecting the power cord to your home terminal

Before you connect your home terminal to a wall outlet, connect the polarized socket on the power cord into the plug labeled "POWER INPUT" on your home terminal's rear panel.

### Connecting equipment to the AC wall outlets

Connect the polarized plugs on the power cords from your home terminal, VCR and any other equipment into AC wall outlets. If these outlets have switches, switch them to ON.

# CONNECTING TO THE AC POWER SUPPLY (CONT.)

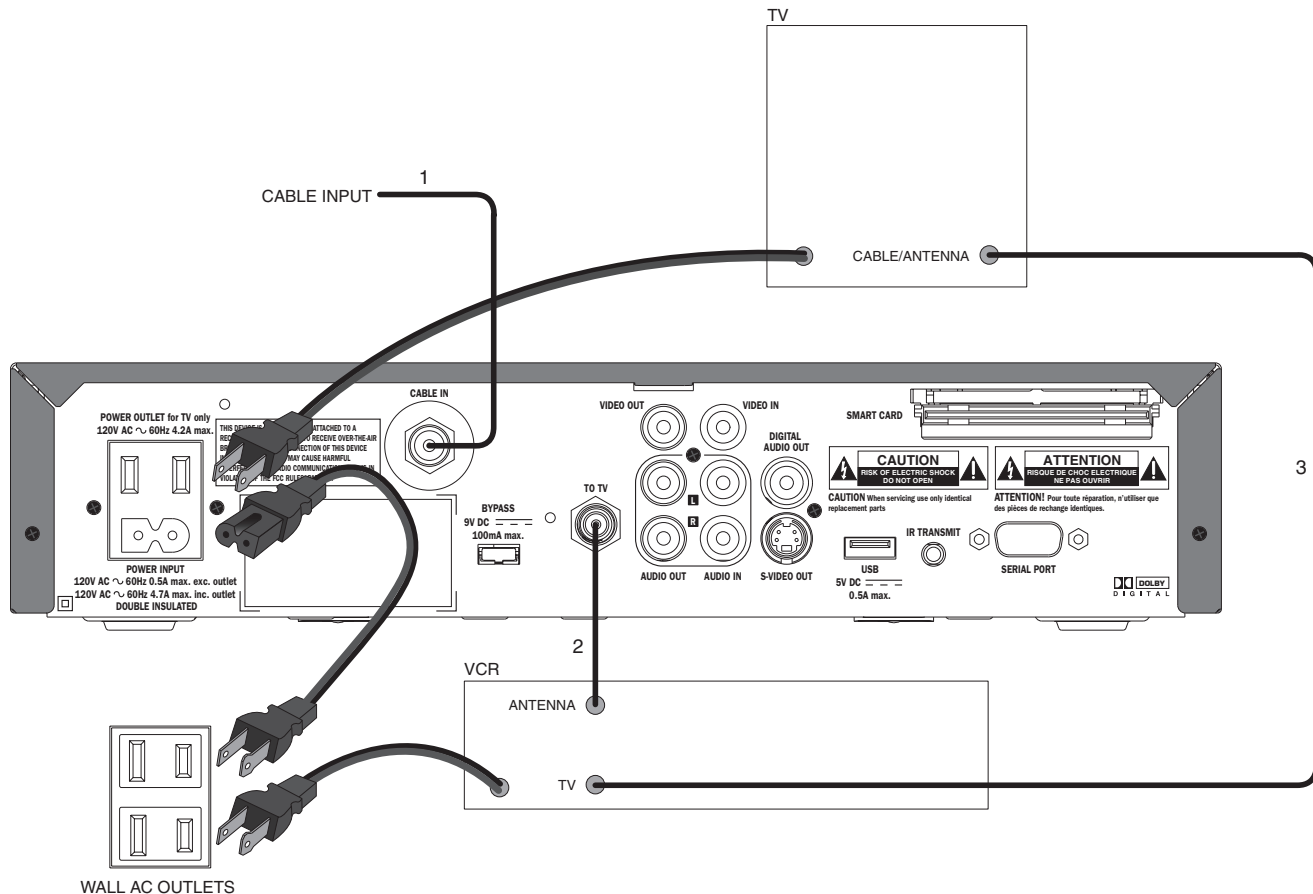

## TURNING ON AND TUNING IN

### Turning on your home terminal

#### NOTE

It is important to wait for the time to appear on the display before you turn on your home terminal. When the time display appears, your home terminal has received all its data from the cable, including any updates that are available.

After you have connected your home terminal to the AC wall outlet (and switched this outlet ON, if it has a switch), wait until you can see the time on its front-panel display.

Press the button labeled "POWER" on the front panel of your home terminal to turn it on.

The word POWER lights up on the front panel, to show that your home terminal is ON.

### Tuning your TV and VCR to your home terminal

The signal at the RF output of your home terminal (labeled "TO TV") is on either channel 3 or channel 4, depending on where you live. For you to be able to watch or record the programs from this output, your TV and VCR (or other equipment) must be tuned to the correct channel. The installer will probably have done this tuning for you. However, if you get a new TV or VCR, or if you need to tune for any other reason, carry out the following steps.

1. Contact your cable operator to find out the correct channel for your location (3 or 4).  
This is your home terminal's RF output channel.
2. Make sure that all of the equipment, including your home terminal, is turned on.  
Make sure that you have NOT selected a baseband input at your TV.  
Make sure that the bypass feature is turned off (BYPASS is NOT lighted on the front panel).
3. Switch the TV/VCR switch on your VCR to "TV".

*Wait for the time to display*

*Turn on your home terminal*



*Make sure that "POWER" lights up*

## TURNING ON AND TUNING IN (CONT.)

4. Tune your TV to your home terminal's RF output channel (3 or 4, as identified by your cable operator). If you do not know how to do this, consult the manual that came with your TV.

You should now be able to see on your TV a program that is coming from your home terminal. If you cannot see a program, check that the RF coaxial cables are securely and correctly connected (as shown on page 11). If there is still a problem, check with your cable operator that you are using the correct RF output channel (either 3 or 4).

5. When you can see a home-terminal program on your TV, switch the TV/VCR switch on your VCR to "VCR".

If you can still see the picture on your TV, everything is tuned correctly. If the picture disappears, carry out the following final step.

6. Tune your VCR by setting the VCR's RF output channel to the **same** RF channel number as the home terminal and TV (either 3 or 4). If you do not know how to do this, consult the manual that came with your VCR.

Everything should now be tuned correctly.

### NOTES

Regardless of the **program** channel number you select on your home terminal, the **RF output** channel number will always be fixed (either 3 or 4, as quoted by your cable operator). Your TV and VCR must be tuned to that channel if you want to watch and record programs through the RF coaxial cables.

You can use the General Settings screen to set the POWER OUTLET (AC Outlet) on your home terminal to be "Always on" or "On with cable box (Settop)". With this second setting, a TV attached to POWER OUTLET will turn off when you turn off your home terminal and will turn on when you turn on your home terminal.

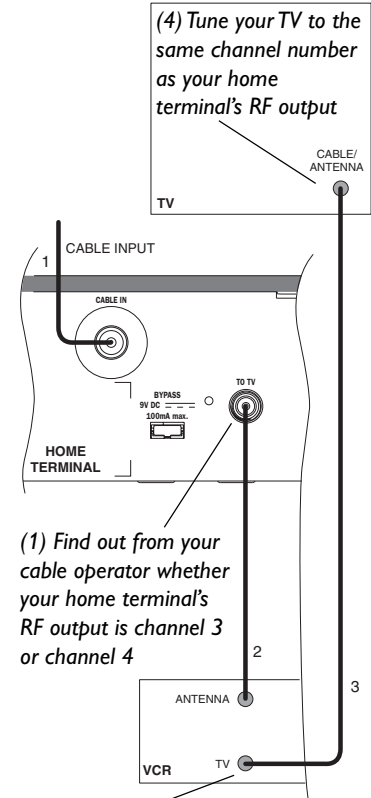

(4) Tune your TV to the same channel number as your home terminal's RF output

(1) Find out from your cable operator whether your home terminal's RF output is channel 3 or channel 4

(6) Set your VCR's RF output to the same channel number as your home terminal's RF output

## OPERATING YOUR HOME TERMINAL

To turn your home terminal on or off at any time, press the POWER button on its front panel or the CBL button on your remote control. When the home terminal is on, the word POWER is lighted on its front panel.

### NOTE

It is important that, unless there is a lightning storm or you will be away from your home for a long time, you do not unplug your home terminal at the wall AC outlet (or do not switch it off there, if the outlet has a switch). Your home terminal can not be updated with new features, through the cable, if it is disconnected from the AC power supply.

### Using your remote control and the on-screen information

It is your cable TV service provider that determines the digital channels, services and screen information that you see on your TV.

Consult the information supplied by your cable operator for details on how to make the most of the digital cable services. Also read the operating instructions that are supplied with your remote control.

### Using the front-panel buttons

You can use the buttons on the front panel to operate your home terminal, if, for example, there is a problem with your remote control. See the diagram on page 16.

### Lightning storms

Occasionally, a lightning storm may affect your home terminal. It may appear that it has stopped working, but you can easily restore its operation as follows.

Unplug your home terminal's power cord at the wall AC outlet. Then plug this power cord in again at the wall AC outlet (and, if there is a switch by this outlet, switch it to its ON position).

### Using a bypass module

If a bypass module has been installed on the rear panel of your home terminal, the regular (analog) channels can bypass your home terminal. For the bypass module to work properly, your home terminal must be connected to the AC power supply and turned on (so that POWER is lighted on its front panel).

To turn on the bypass feature, press the BYPASS button on your remote control.

To turn off the bypass feature, press the BYPASS button again.

While the bypass is on, the word BYPASS is lighted on the front panel of your home terminal.

**When the bypass is on**, you can use the TV's remote control to tune to any of the available regular channels and watch that channel on your TV. This may be a different channel from the channel that your home terminal is tuned to. (The number of the channel it is tuned to is shown on its front panel.) You can record on your VCR the channel that your home terminal is tuned to. This means that, when the bypass is on, you can watch a regular (analog) channel on your TV and, at the same time, record a **different** channel (digital or analog) on your VCR.

**When the bypass is off**, you will see on your TV the channel that your home terminal is tuned to. This is the same channel that your VCR receives. So, when the bypass is off, you can record only the channel that you are watching on your TV.

### Activating baseband loopthrough for a DVD or similar equipment

If you activate baseband loopthrough, your home terminal loops the inputs at its VIDEO IN and AUDIO IN jacks through to its VIDEO OUT and AUDIO OUT jacks. You need to do this if you have connected a DVD player or similar equipment and wish to watch it on your TV.

To activate baseband loopthrough, press the BYPASS button on the remote control (so that BYPASS on the front panel is lighted). Then press the CBL button on the remote (or the POWER button on the front panel) to turn off the home terminal.

## FRONT PANEL

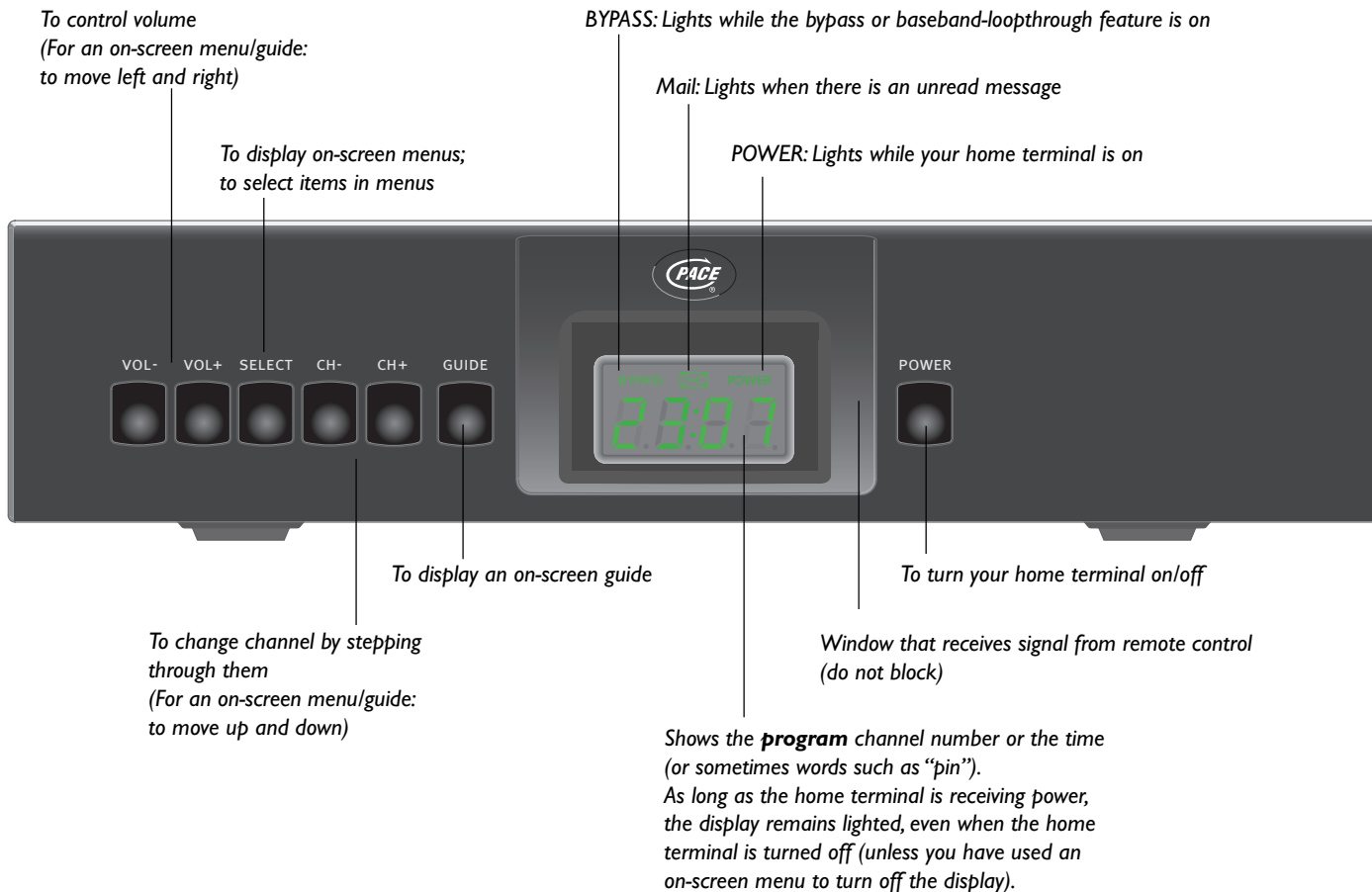

If the installed system does not seem to be working properly, *firstly make sure that all the cables are securely connected*, then carry out the following checks, in the order shown.

Check	Suggested solution	Further checks, if there is still a problem
<p>Is anything lighted on your home terminal's front panel?</p> <p style="text-align: right;">NO ►</p> <p style="text-align: left;">YES ▼</p>	<p>Power may not be reaching your home terminal. Make sure that the power cord is properly plugged in. If there is a switch by the wall AC power outlet, switch it to ON.</p>	<p>Check that the wall AC power outlet is working (for example by plugging in a lamp).</p> <p>Check that you have not turned off the front-panel display using an on-screen menu.</p>
<p>Does the remote control operate your home terminal?</p> <p style="text-align: right;">NO ►</p> <p style="text-align: left;">YES ▼</p> <p>Please see the next page</p>	<p>Your home terminal may not be turned on. Check if the word POWER is lighted on the front panel. If it is not, press the POWER button on the front panel.</p>	<p>Check that nothing is blocking the path from your remote control and the front panel.</p> <p>Check that your remote control is currently set to operate your home terminal (consult the instructions supplied with your remote control).</p> <p>If your remote control will still not operate your home terminal, replace the batteries in your remote control.</p> <p>If there is still a problem, try to operate your home terminal by using its front-panel buttons. If this works, then your remote control may be faulty.</p>

## SOLVING PROBLEMS (CONT.)

Check	Suggested solution	Further checks, if there is still a problem
<p>Can you see a picture on your TV screen?</p> <p>NO ►</p> <p>YES ▼</p>	<p>Your TV and other equipment may not be turned on. Check that they are plugged into AC power outlets and turned on.</p> <p>[Note: In the General Settings screen, "AC Outlet" may be set to "On with cable box (Settop)". If you have connected your TV to the POWER OUTLET (AC outlet) on your home terminal, the setting "On with cable box (Settop)" means that, when you turn off your home terminal, your TV will turn off, and, when you turn on your home terminal, your TV will turn on. You may wish to keep this feature, or you may wish to set "AC Outlet" to "Always on".]</p>	<p>Make sure the bypass feature is turned OFF (the word BYPASS on the front panel is not lighted).</p> <p>If your stereo TV is connected by AV cables, select the appropriate baseband input on your TV.</p> <p>If your TV and VCR are connected by RF coaxial cables (as shown on page 11), they must be tuned to your home terminal's output channel. This is channel 3 or channel 4 (contact your cable operator to find out which it is). Tune your TV and VCR to this channel (see page 12).</p>
<p>Is the picture distorted?</p> <p>YES ►</p> <p>NO ▼</p>	<p>Your TV and/or VCR may not be tuned to your home terminal's output channel. See above and also page 12.</p>	<p>Make sure that the TV/VCR switch on your VCR is switched to "TV".</p>
<p>Is there any sound?</p> <p>NO ►</p> <p>YES ▼</p> <p>Please see the next page</p>	<p>Check that the audio cables are securely and correctly connected.</p>	<p>Check that you have not muted the sound on your home terminal and/or TV.</p> <p>Adjust the volume control on your home terminal and/or TV.</p>





[www.pacemicro.com](http://www.pacemicro.com)

Pace<sup>®</sup> and  are trademarks and/or registered trademarks of Pace Micro Technology plc.

**502-1409303**