

Pace DC511P

Operator's Manual



www.pacemicro.com



Manufactured under license from Dolby Laboratories.
 "Dolby" and the double-D symbol are trademarks of
 Dolby Laboratories. Confidential Unpublished Works.
 ©1992-1997 Dolby Laboratories, Inc. All rights reserved.

This product incorporates copyright protection technology that is protected by U.S. patents and other intellectual property rights. Use of this copyright protection technology must be authorized by Macrovision, and is intended for home and other limited pay-per-view uses only unless otherwise authorized by Macrovision. Reverse engineering or disassembly is prohibited.

Pace and  are trademarks of Pace Micro Technology plc.

PowerKEY and the PowerKEY design are registered trademarks of Scientific-Atlanta, Inc.

Other trademarks listed herein are the property of their respective owners.

The model and serial number of your Pace DC511P set-top are on a label on its base.

Copyright © 2005 Pace Micro Technology plc All rights reserved

SAFETY INFORMATION	2
IMPORTANT SAFETY INSTRUCTIONS	3
REAR PANEL	8
CONNECTING TO THE AC POWER SUPPLY	10
Connecting your TV to the AC power supply	10
Connecting the power cord to your set-top	10
Connecting equipment to the AC wall outlets	10
TURNING ON AND TUNING IN	12
Turning your set-top on and off	12
Tuning your TV and VCR to your set-top	13
Lightning storms	14
OPERATING YOUR SET-TOP	15
Using your remote control	15
Activating baseband loopthrough for a DVD or similar equipment	15
Using the front-panel buttons	16
Using an RF-bypass module	17
SOLVING PROBLEMS	18

SAFETY INFORMATION

This digital set-top has been manufactured and tested with your safety in mind. However, improper use can result in potential electric shock or fire hazards. To avoid defeating the safeguards that have been built into your set-top, please observe the precautions discussed in this document.

WARNINGS ON YOUR SET-TOP



The lightning flash with arrowhead symbol, within a triangle, is intended to alert you to the presence of uninsulated "dangerous" voltages within your set-top's enclosure that may be of sufficient magnitude to constitute a risk of electric shock to persons.



The exclamation point within a triangle is intended to alert you to the presence of important instructions in the literature accompanying your set-top.

OTHER WARNINGS

TO REDUCE THE RISK OF ELECTRIC SHOCK, DO NOT REMOVE THE COVER OF YOUR SET-TOP.

THERE ARE NO USER-SERVICEABLE PARTS INSIDE IT.

TO REDUCE THE RISK OF FIRE OR ELECTRIC SHOCK, DO NOT EXPOSE THIS SET-TOP TO RAIN OR MOISTURE.

DO NOT PERFORM ANY SERVICING UNLESS YOU ARE QUALIFIED TO DO SO BY PACE. REFER ALL SERVICING TO QUALIFIED SERVICE PERSONNEL. SERVICING THE SET-TOP YOURSELF WILL INVALIDATE THE WARRANTY.

INSTALLATION

The installation of your set-top should be carried out by a qualified installer and should conform to local codes.

Note to the installer

This reminder is provided to call the attention of the cable-TV-system installer to Section 820-40 of the National Electrical Code (USA), which provides guidelines for proper grounding and, in particular, specifies that the cable ground shall be connected to the grounding system of the building, as close to the point of cable entry as is practical.

Service address:

Pace Micro Technology (Support Services) Ltd.
3701 FAU Boulevard, Suite 200
Boca Raton
Florida, 33431, U.S.A.

IMPORTANT SAFETY INSTRUCTIONS

Before you install or use the apparatus, you must read and understand these Important Safety Instructions. At all times when using the apparatus you must follow these Important Safety Instructions to reduce the risk of fire, electrical shock and injury to persons.

1. Read these instructions.
2. Keep these instructions.
3. Heed all warnings.
4. Follow all instructions.
5. Do not use this apparatus near water.
6. Clean only with dry cloth.
7. Do not block any ventilation openings. Install in accordance with the manufacturer's instructions.
8. Do not install near any heat sources such as radiators, heat registers, stoves, or other apparatus (including amplifiers) that produce heat.
9. Do not defeat the safety purpose of the polarized or grounding-type plug. A polarized plug has two blades with one wider than the other. A grounding type plug has two blades and a third grounding prong. The wide blade or the third prong are provided for your safety. If the provided plug does not fit into your outlet, consult an electrician for replacement of the obsolete outlet.
10. Protect the power cord from being walked on or pinched particularly at plugs, convenience receptacles, and the point where they exit from the apparatus.
11. Only use attachments/accessories specified by the manufacturer.
12. Use only with the cart, stand, tripod, bracket, or table specified by the manufacturer, or sold with the apparatus. When a cart is used, use caution when moving the cart/apparatus combination to avoid injury from tip-over.



13. Unplug this apparatus during lightning storms or when unused for long periods of time.
14. Refer all servicing to qualified service personnel. Servicing is required when the apparatus has been damaged in any way, such as power-supply cord or plug is damaged, liquid has been spilled or objects have fallen into the apparatus, the apparatus has been exposed to rain or moisture, does not operate normally, or has been dropped.

SAFETY INFORMATION (CONT.)

In addition to the Important Safety Instructions, please read the Safety Information below.

Power sources

You must operate your set-top only from the type of power source indicated on the marking label. If you are not sure of the type of power supply to your home, consult your dealer or local power company.

Overloading

Do not overload wall outlets, extension cords or other power outlets as this can result in a risk of fire or electric shock.

Lightning

For added protection for your set-top during a lightning storm, or when it is left unattended and unused for long periods of time, disconnect the antenna, cable system and telecommunication line cord from your set-top. See also item 13 in the Important Safety Instructions.

Placement and mounting

Do not place your set-top on an unstable or uneven surface. Your set-top may fall, causing serious injury to a child or adult and serious damage to your set-top. If you mount your set-top, for example to a wall or ceiling, follow the manufacturer's instructions and use a mounting accessory recommended by the manufacturer. See also item 12 in the Important Safety Instructions.

Ventilation

Slots and openings in the casing of your set-top are provided for ventilation, to ensure reliable operation of your set-top and to protect it from overheating.

- never block the ventilation openings by placing your set-top on a bed, sofa, rug or other similar surface;
- never cover the ventilation openings with items such as newspapers, table-cloths or curtains;
- do not place your set-top in a built-in installation such as a bookcase or rack unless proper ventilation is provided or you have adhered to the manufacturer's instructions;
- maintain a minimum distance of 3 inches around your set-top for sufficient ventilation.

See also item 7 in the Important Safety Instructions.

Water and moisture

Do not expose this set-top to dripping or splashing and ensure that no objects filled with liquids, such as vases, are placed on your set-top. See also item 5 in the Important Safety Instructions.

Entry of objects and liquids

Never push objects of any kind into your set-top through openings as they may touch dangerous voltage points or short-out parts that could result in fire or electric shock. Never spill liquid of any kind on your set-top.

Risk of fire or scorching

Never place naked flame sources, such as lighted candles, on your set-top.

Outdoor antenna grounding

Be sure that any outside antenna or cable system connected to your set-top is grounded so as to provide some protection against voltage surges and static charges that have built up. Article 810 of the National Electrical Code (USA), ANSI/NFPA 70 provides information with regard to proper grounding of the mast and supporting structure, grounding of the lead-in wire to an antenna-discharge unit, size of grounding conductors, location of antenna-discharge unit, connection to grounding electrodes and requirements for the grounding electrode. See the diagram below.

(Example antenna grounding as per National Electrical Code, ANSI/NFPA 70)

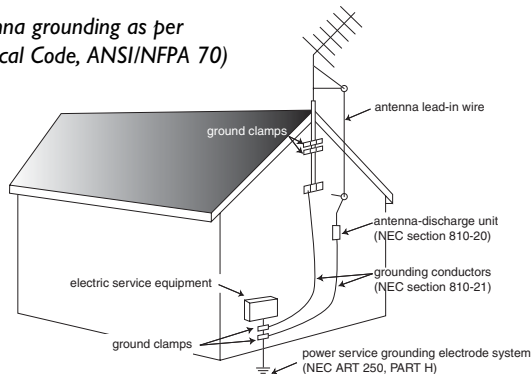

Power lines

You must not locate an outside antenna system in the vicinity of overhead power lines or other electric light or power circuits, or where it can fall into such power lines or circuits. When installing an outside antenna system, you must take extreme care to avoid touching such power lines or circuits, as contact with them might be fatal.

Transporting

Move the combination of set-top and cart with care. Quick stops, excessive force and uneven surfaces may cause the combination of set-top and cart to overturn. See also item 12 in the Important Safety Instructions.

Ambient temperature

The operating temperature range of your set-top is 32-104°F. If the ambient temperature around your set-top falls outside this range, you must correct this in order for your set-top to work correctly and safely. For example, if the temperature is too high, switch on the air conditioning.

Replacement parts

When replacement parts are required, be sure that the service technician has used replacement parts specified by the manufacturer or that have the same characteristics as the original part. Unauthorized substitutions may result in fire, electric shock or other hazards. See also item 14 in the Important Safety Instructions.

SAFETY INFORMATION (CONT.)

Safety check

Upon completion of any servicing or repairs to your set-top, ask the service technician to perform safety checks to determine that your set-top is in its proper operating condition. See also item 14 in the Important Safety Instructions.

SAVE THIS INFORMATION FOR FUTURE REFERENCE

The POWER OUTLET plug is designed only for connection to the AC power cord for a TV. The maximum power it can supply is 500 watts. Do not connect any equipment that uses more than 500 watts, or any non-TV equipment such as a toaster or hair drier.

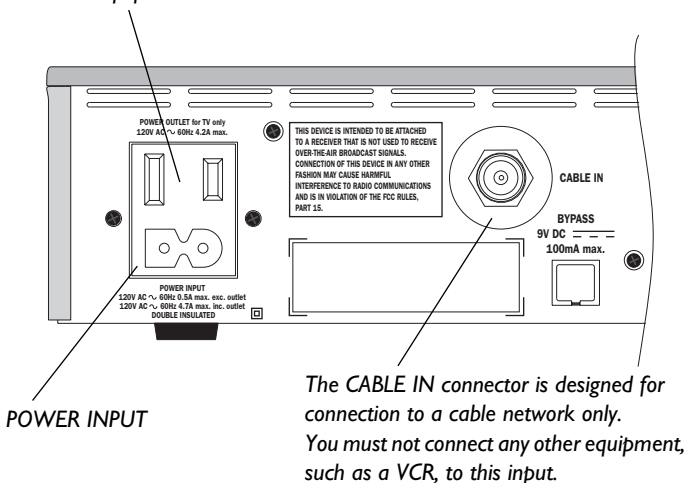

SAFETY ASPECTS OF CONNECTIONS

Full details of the rear panel are on page 8.

Connecting

Do not connect your set-top (or any other equipment such as a TV or VCR) to the power supply until you have properly connected all the other cables.

Your set-top operates with a 120 V AC, 60 Hz power supply. Do not connect your set-top to any supply other than this.

This set-top is equipped with a two-wire power cord, with a polarized plug at one end. The other end of the cord is fitted with a polarized connector, which is shaped such that it can only be fitted one way into the power input jack of your set-top. Connect this end first, before inserting the polarized plug into the wall socket-outlet.

Disconnecting

Disconnect your set-top from the power supply before you disconnect any other equipment from its rear panel.

The only way to disconnect your set-top from the power supply is to remove the power cord from the wall socket-outlet. Your set-top must therefore be installed near to the wall socket-outlet, which should be easily accessible.

EPILEPSY AND ON-SCREEN IMAGES

Certain people are susceptible to epileptic seizures or losing consciousness when faced with certain types of flashing lights in our daily environment.

These people are exposed to the risk of seizures if they watch certain television images or if they view certain images while they are browsing the Web. These phenomena may appear even when the subject has no previous history of this problem or has never suffered an epileptic seizure.

If you, or a member of your family, has already suffered symptoms linked to epilepsy (seizure or loss of consciousness) in the presence of stimulation by light, please consult your doctor before using this product.

If you or any person using the equipment experiences dizziness, involuntary movements or convulsion, please immediately stop viewing and consult a doctor.

When you are browsing the Web or playing a Web-based game, take the following precautions:

- Use the equipment in a well-lit room, and turn down the brightness of your television screen.
- Sit at a reasonable distance from your television screen.
- Take a break for ten minutes every hour.

You should avoid using the Web if you are tired or have lost some sleep.

REGULATORY INFORMATION

CAUTION: Do not attempt to modify your set-top without written authorization from the manufacturer. Unauthorized modification could void your authority to operate your set-top.

NOTE

Your set-top has been tested and found to comply with the limits for a Class B digital device, pursuant to Part 15 of the FCC Rules. These limits are designed to provide reasonable protection against harmful interference in a residential installation. Your set-top generates, uses and can radiate radio-frequency energy and, if not installed and used in accordance with the instructions, may cause harmful interference to radio communications.

However, there is no guarantee that interference will not occur in a particular installation. If your set-top does cause harmful interference to radio or television reception, which can be determined by turning your set-top off and on, you are encouraged to try to correct the interference by one or more of the following measures:

- Reorient or relocate the receiving antenna.
- Increase the separation between your set-top and the receiver.
- Connect your set-top to an outlet on a circuit different from that to which the receiver is connected.
- Consult your dealer or an experienced radio/TV technician for help.

REAR PANEL

POWER OUTLET
(500 W max.)

VIDEO IN
Video baseband input

IR RECEIVE
Infra-red input from a remote "eye"

CABLE IN
From cable service-provider

AUDIO IN
Audio baseband input
(stereo, L and R)

DIGITAL AUDIO OUT
Electrical S/PDIF audio output

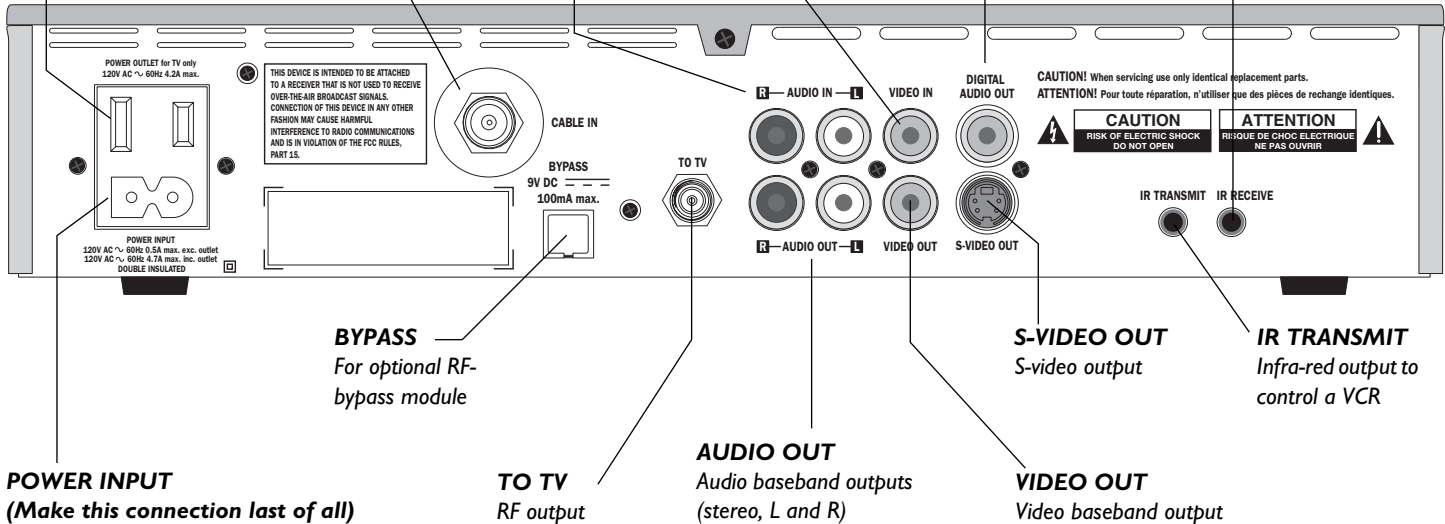

POWER OUTLET	Connect the TV's power cord here to provide AC power to your TV.
POWER INPUT	Connect your set-top's power cord here.
CABLE IN	Connect the incoming cable service here. The optional RF-bypass module also connects here.
BYPASS	Connect an optional (but not supplied) RF-bypass module here, so that it can receive its power from your set-top.
TO TV	Connect to the antenna/cable input on your TV or VCR.
VIDEO OUT	Connect to the video baseband input on your TV or VCR.
S-VIDEO OUT	Connect to the S-video baseband input (if present) on your TV or VCR.
AUDIO OUT	Connect to the stereo audio inputs on your stereo TV, stereo VCR, optional stereo amplifier or home theater receiver.
DIGITAL AUDIO OUT	Connect to the electrical digital audio input (electrical S/PDIF) on optional digital audio equipment, such as an audio decoder or home theater receiver.
VIDEO IN	Connect to the video baseband output on your DVD player (or similar).
AUDIO IN	Connect to the stereo audio outputs on your DVD player (or similar).
IR TRANSMIT	Connect to an optional (but not supplied) VCR controller: (IR transmitter).
IR RECEIVE	Connect to an optional (but not supplied) "remote eye" (IR receiver).

WARNINGS

Do not connect your set-top (or any other equipment such as a TV or VCR) to the AC power supply until you have properly connected all the other cables.

Disconnect your set-top from the AC power supply before you disconnect any other equipment from its rear panel.

The power outlet is designed only for connection to the AC power cord for a TV. The maximum power it can supply is 500 watts. Do not connect any equipment that uses more than 500 watts, or any non-TV equipment such as a toaster or hair dryer.

The cable input is designed for connection to a cable network only. You must not connect any other equipment, such as a VCR, to this input.

Any cable connected to DIGITAL AUDIO jacks must be 75 ohm coaxial, not regular audio cable.

CONNECTING TO THE AC POWER SUPPLY

WARNINGS

Do not connect your set-top (or any other equipment such as a TV or VCR) to the AC power supply until you have properly connected all the other cables.

Do not defeat the safety purpose of the polarized plugs on power cords. A polarized plug has two blades with one wider than the other. This plug fits into the outlet in only one way; match the wide blade of the plug to the wide slot of the outlet.

Disconnect your set-top from the AC power supply before you disconnect any other equipment from its rear panel.

The only way to disconnect your set-top from the AC power supply is to remove the AC power cord (or switch the wall socket-outlet switch, if present, to its OFF position). Your set-top must therefore be installed near to the AC power socket-outlet, which should be easily accessible.

CONNECTING YOUR TV TO THE AC POWER SUPPLY

If your TV has a rating of less than 500 W, connect the power cord from your TV into the connector labeled "POWER OUTLET" on the rear panel of your set-top. This saves a wall outlet (although, if your TV is rated 500 W or more, you must connect it to a wall outlet).

CONNECTING THE POWER CORD TO YOUR SET-TOP

Before you connect your set-top to a wall outlet, connect the polarized socket on the power cord into the plug labeled "POWER INPUT" on your set-top's rear panel.

CONNECTING EQUIPMENT TO THE AC WALL OUTLETS

Connect the polarized plugs on the power cords from your set-top, VCR and any other equipment into AC wall outlets. If these outlets have switches, switch them to ON.

CONNECTION TO THE AC POWER SUPPLY (CONT.)

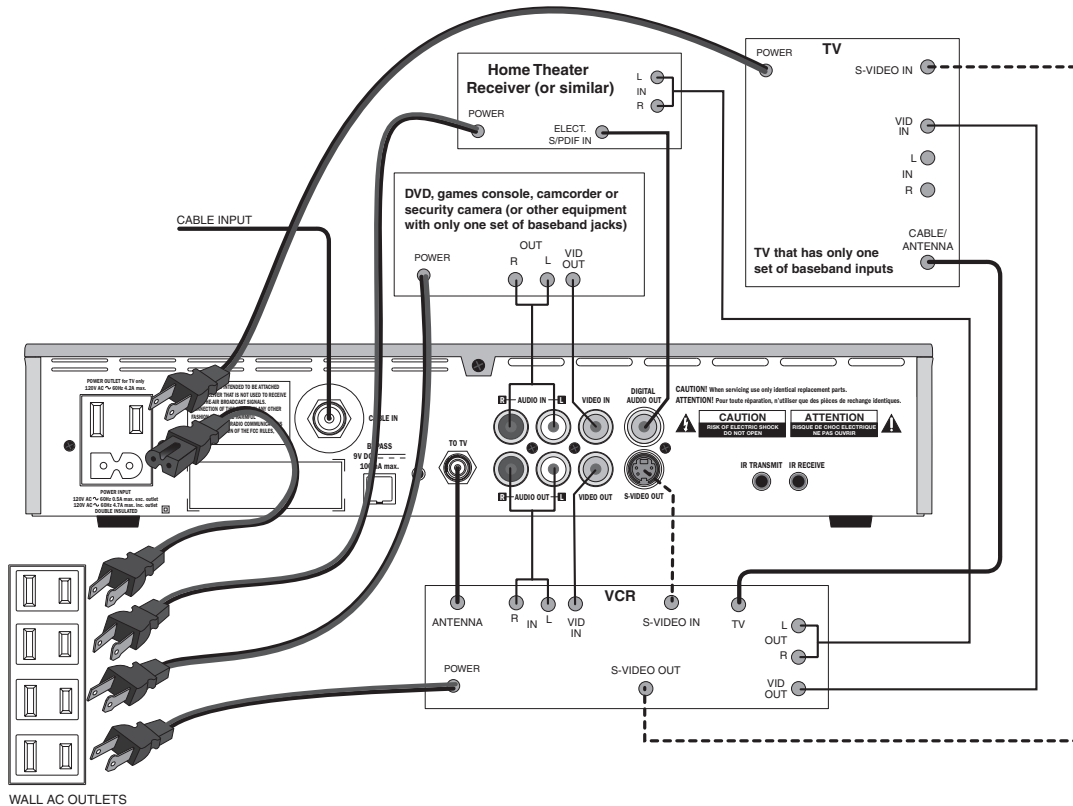

TURNING ON AND TUNING IN

TURNING YOUR SET-TOP ON AND OFF

After you have connected your set-top to the AC wall outlet (and switched this outlet ON, if it has a switch), the light around the **power** button on your set-top's front panel should be red.

Wait for a few seconds, then press the button labeled **power** on the front panel of your set-top to turn it on. The light around the **power** button goes from red to green, to show that your set-top is on.

If the light around the **power** button is neither red nor green, there is a problem.

To turn your set-top on or off at any time, press the **power** button on its front panel or the **CBL** button on your remote control.



*To turn on your set-top, press the **power** button.*

The light around the button changes from red to green.

NOTES

It is important that, unless there is a lightning storm or you will be away from your home for a long time, you do not unplug your set-top at the wall AC outlet (or do not switch it off there, if the outlet has a switch). Your set-top can not be updated with new features, through the cable, if it is disconnected from the AC power supply.

You can use the General Settings screen to set the POWER OUTLET (AC Outlet) on your set-top to be "Always on" or "On with cable box (Settop)". With this second setting, a TV attached to POWER OUTLET will turn off when you turn off your set-top and will turn on when you turn on your set-top.

TUNING YOUR TV AND VCR TO YOUR SET-TOP

The signal at the RF output of your set-top (labeled "TO TV") is on either channel 3 or channel 4, depending on where you live. For you to be able to watch or record the programs from this output, your TV and VCR (or other equipment) must be tuned to the correct channel. The installer will probably have done this tuning for you. However, if you get a new TV or VCR, or if you need to tune for any other reason, carry out the following steps.

1. Contact your cable operator to find out the correct channel for your location (3 or 4).

This is your set-top's RF output channel.

2. Make sure that all of the equipment, including your set-top, is turned on.
Make sure that you have NOT selected a baseband input at your TV.
Make sure that the RF-bypass feature is turned off (BYPASS is NOT lighted on the front panel).
3. Switch the TV/VCR switch on your VCR to "TV".
4. Tune your TV to your set-top's RF output channel (3 or 4, as identified by your cable operator).
If you do not know how to do this, consult the manual that came with your TV.

You should now be able to see on your TV a program that is coming from your set-top. If you cannot see a program, check that the RF coaxial cables are securely and correctly connected (as shown on page 11). If there is still a problem, check with your cable operator that you are using the correct RF output channel (either 3 or 4).

5. When you can see a home-terminal program on your TV, switch the TV/VCR switch on your VCR to "VCR".

If you can still see the picture on your TV, everything is tuned correctly.

If the picture disappears, carry out the following final step (please see the next page).

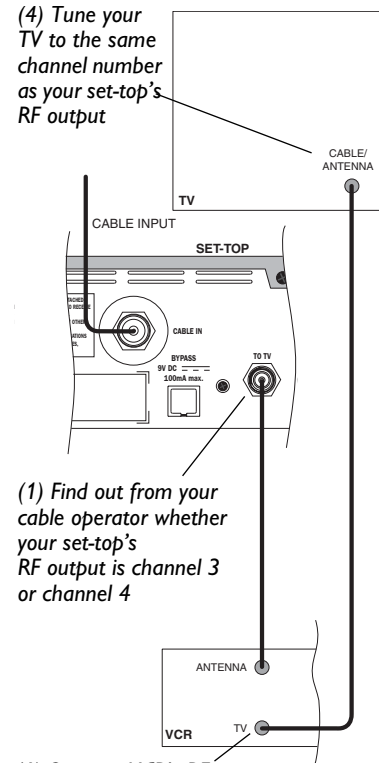

(4) Tune your TV to the same channel number as your set-top's RF output

(1) Find out from your cable operator whether your set-top's RF output is channel 3 or channel 4

(6) Set your VCR's RF output to the same channel number as your set-top's RF output.

TURNING ON AND TUNING IN (CONT.)

6. Tune your VCR by setting the VCR's RF output channel to the same RF channel number as the set-top and TV (either 3 or 4). If you do not know how to do this, consult the manual that came with your VCR.

Everything should now be tuned correctly.

NOTE

Regardless of the **program** channel number you select on your set-top, the **RF output** channel number will always be fixed (either 3 or 4, as quoted by your cable operator). Your TV and VCR must be tuned to that channel if you want to watch and record programs through the RF coaxial cables.

LIGHTNING STORMS

Occasionally, a lightning storm may affect your set-top. It may appear that it has stopped working, but you can easily restore its operation as follows.

Unplug your set-top's power cord at the wall AC outlet. Then plug this power cord in again at the wall AC outlet (and, if there is a switch by this outlet, switch it to its ON position).

USING YOUR REMOTE CONTROL

It is your cable TV service provider that determines the digital channels, services and screen information that you see on your TV when you use your set-top and its remote control.

Consult the information supplied by your cable operator for details on how to make the most of the digital cable services. Also read the operating instructions that are supplied with your remote control.

ACTIVATING BASEBAND LOOPTHROUGH FOR A DVD OR SIMILAR EQUIPMENT

To activate baseband loopthrough, simply turn off your set-top by pressing the **CBL** button on your remote control (or the **power** button on the front panel). When your set-top is off, the light around the **power** button is red.

If you activate baseband loopthrough, your set-top loops various inputs on its rear panel to corresponding outputs as shown in the table below. You need to do this if you have connected a DVD player or similar equipment and wish to watch it on your TV.

VIDEO IN	loops through to	VIDEO OUT
AUDIO IN	loops through to	AUDIO OUT

OPERATING YOUR SET-TOP (CONT.)

USING THE FRONT-PANEL BUTTONS

You can use the buttons on the front panel to operate your set-top, if, for example, there is a problem with your remote control.

power button

To turn your set-top on/off

Window that receives signal from remote control (do not block it)

Smart-card slot: Do not use it unless the cable operator asks you to

settings button

To display on-screen menus

USB connector: to connect equipment that has a USB interface, e.g. digital camera, keyboard or mouse

BYPASS: Lights while the RF-bypass feature is on

MAIL: Lights when there is an unread message

select button (+)

To select items in menus/guides



power light (around button)

Lights green when your set-top is on and red when it is off

Shows the **program** channel number or the time (or sometimes other information)

To display an on-screen guide

To display on-screen program information

To remove on-screen information

To change channel or move up/down in an on-screen menu/guide

To adjust volume or move left/right in an on-screen menu/guide

USING AN RF-BYPASS MODULE

If an RF-bypass module has been installed on the rear panel of your set-top, the regular (analog) channels can bypass your set-top. For you to turn the RF-bypass on or off, your set-top must be turned on. However, once set, the RF-bypass will work even when your set-top is turned off.

To turn on the RF-bypass feature, press the **BYPASS** button on your remote control.

To turn off the RF-bypass feature, press the **BYPASS** button again.

While the RF-bypass is on, the word BYPASS is lighted on the front panel of your set-top.

When the RF-bypass is on, you can use the TV's remote control to tune to any of the available regular (analog) channels and watch that channel on your TV. This may be a different channel from the channel that your set-top is tuned to. (The number of the channel it is tuned to is shown on its front panel.) You can record on your VCR the channel that your set-top is tuned to. This means that, when the RF-bypass is on, you can watch a regular (analog) channel on your TV and, at the same time, record a *different* channel (digital or analog) on your VCR.

When the RF-bypass is off, you will see on your TV the channel that your set-top is tuned to. This is the same channel that your VCR receives. So, when the RF-bypass is off, you can record only the channel that you are watching on your TV.

SOLVING PROBLEMS

If the installed system does not seem to be working properly, **first make sure that all the cables are securely connected**, then carry out the following checks, in the order shown.

Check	Suggested solution	Further checks, if there is still a problem
<p>Is anything lighted on your set-top's front panel?</p> <p style="text-align: center;">NO ►</p> <p style="text-align: center;">YES ▼</p>	<p>Power may not be reaching your set-top. Make sure that the power cord is properly plugged in. If there is a switch by the wall AC power outlet, switch it to ON.</p>	<p>Check that the wall AC power outlet is working (for example by plugging in a lamp).</p>
<p>Does the remote control operate your set-top?</p> <p style="text-align: center;">NO ►</p> <p style="text-align: center;">YES ▼</p> <p>Please see the next page</p>	<p>Your set-top may not be turned on. Check if the light around the power button on the front panel is green. If it is red, press the power button on the front panel to turn on your set-top.</p>	<p>Check that nothing is blocking the path from your remote control to the front panel (or remote eye, if you are using one).</p> <p>Check that your remote control is currently set to operate your set-top (consult the instructions supplied with your remote control).</p> <p>If your remote control will still not operate your set-top, replace the batteries in your remote control.</p> <p>If there is still a problem, try to operate your set-top by using its front-panel buttons. If this works, then your remote control may be faulty.</p>

Check	Suggested solution	Further checks, if there is still a problem
<p>Can you see a picture on your TV screen?</p> <p style="text-align: right;">NO ▶</p> <p style="text-align: center;">YES ▼</p>	<p>Your TV and other equipment may not be turned on. Check that they are plugged into AC power outlets and turned on.</p> <p>Note: In the General Settings screen, “AC Outlet” may be set to “On with cable box (Settop)”. If you have connected your TV to the POWER OUTLET (AC outlet) on your set-top, the setting “On with cable box (Settop)” means that, when you turn off your set-top, your TV will turn off, and, when you turn on your set-top, your TV will turn on. You may wish to keep this feature, or you may wish to set “AC Outlet” to “Always on”.</p>	<p>Make sure the RF-bypass feature is turned OFF (the word BYPASS on the front panel is not lighted). If your stereo TV is connected by baseband AV cables, check that you have selected the appropriate baseband input on your TV. If your TV and VCR are connected by RF coaxial cables, they must be tuned to your set-top’s output channel. This is channel 3 or channel 4 (contact your cable operator to find out which it is). Tune your TV and VCR to this channel (see page 13). If the video path between your set-top and your TV loops through other equipment (such as a VCR) you may need to turn off this equipment for the loopthrough to work.</p>
<p>Is the picture distorted or too small?</p> <p style="text-align: right;">YES ▶</p> <p style="text-align: center;">NO ▼</p> <p>Please see the next page</p>	<p>Your TV and/or VCR may not be tuned to your set-top’s output channel. See above and also page 13.</p>	<p>Make sure that the TV/VCR switch on your VCR is switched to “TV”.</p>

SOLVING PROBLEMS (CONT.)

Check	Suggested solution	Further checks, if there is still a problem
<p>Is there any sound?</p> <p style="text-align: right;">NO ▶</p> <p style="text-align: center;">YES ▼</p>	<p>Check that the audio cables are securely and correctly connected.</p>	<p>Check that you have not muted the sound on your set-top, TV and/or any attached audio equipment. Adjust the volume control on your set-top and/or TV.</p> <p>If you can hear only mono sound, first check that the program is likely to have stereo sound (an old movie, for example, may not be in stereo).</p>
<p>Can you see and hear a DVD that you are trying to play?</p> <p style="text-align: right;">NO ▶</p> <p style="text-align: center;">YES ▼</p>	<p>For the signal to loop through your set-top from a DVD (or similar equipment) to reach your TV, you must activate baseband loopthrough by turning off your set-top.</p>	<p>Check that all the audio and video cables are securely and correctly connected, including any to a home theater receiver that you may be using to enhance the sound.</p>
<p>Can you see only regular (analog) channels but not any digital channels?</p> <p style="text-align: right;">YES ▶</p>	<p>The RF-bypass feature may be turned on. Press the BYPASS button on your remote control to turn the feature OFF (make sure the word BYPASS is not lighted on the front panel).</p>	



www.pacemicro.com

Pace and  are trademarks and/or registered trademarks of Pace Micro Technology plc.

502-1406102